



HERDEN IMMOBILIEN®

— *Finest Properties* —



FINCA PUERTO DE SOLLER MALLORCA FOR RENT

4.900 €

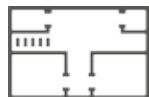

225 m²



4



2

Beschreibung

Herdén Real Estate rents this beautiful rustic finca - a truly unique property within walking distance to the port of Sóller.

This traditional property combines Majorcan style with generous comfort and offers breathtaking sea and mountain views.

Peace and nature combined with luxury and first class comfort - this is the best way to describe Can Pinarett.

We are looking for a long-term tenant who feels at home on the island of Mallorca. Can Pinarett is perfect for families, people who want to enjoy peace and quiet, for those moving to Mallorca and looking for that little extra, as well as for remote workers who want to work and relax in tranquil surroundings.

Discover the charm and uniqueness of Can Pinarett - your new home in Mallorca awaits you!

Location

Can Pinarett is located near the idyllic village of Sóller, in the heart of the Serra de Tramuntana in the picturesque northwest of Mallorca. This region is known as a paradise for hikers, cyclists and water sports enthusiasts. Situated on a hill, the finca offers a unique view of the harbour of Port de Sóller. The harbour and the beach can be reached within a few minutes by car.

If you are interested in this beautiful finca, please do not hesitate to contact us for an appointment.

Legal contractual conditions for the rental of this property:

Rental period of more than 32 days and a maximum of 11 months. After 11 months, the contract can always be extended for another 11 months if desired.

Rental deposit: 1 months rent.

Agent's commission: 1 months rent plus VAT for a long rental period of 11 months, including the option of further extensions.

For short term rentals, but longer than 32 days, it is 15% of the total rental price for the entire rental period.

For a temporary rental period of up to 11 months and using our services, the tenant is legally obliged to pay the agent's commission of 1.5 months rent plus VAT.

Weitere Daten



Gästetoilette 1

Möbliert

Klimaanlage Warm / Kalt

Kamin

Nutzfläche 200 m²

Swimmingpool

Heizung



angeforde
rt

Energiezertifikat

Emissionen CO2



